



Georgia World
Congress Center
Authority



FLOOR PLANS

Georgia World Congress Center
Centennial Olympic Park

gwcca.org

IT TAKES
A TEAM!
THE BLOOD CONNECTION

How can we accommodate you?

International Plaza

Whether it's the right size space to excite your sales force about a new innovation or the perfect area to generate an early buzz for your business, what you choose plays an important part in your success.





The following floor plans give you all of the specific detail to determine how the Georgia World Congress Center can accommodate your needs.

Not only do we have the space to handle just about any function, you'll find it comes with unsurpassed flexibility and a staff of experts who will have the answers you require.

Snapshot of the Georgia World Congress Center

- 4.1+ million square feet of total space
- 1.5 million square feet of flexible space
- 98 meeting rooms
- 2 high-end boardrooms
- 2 ballrooms
- 3 fixed seat auditoriums
- 7,000 parking spaces in decks and surface lots
- Fully ADA accessible
- Complete network connectivity, telecom solutions, and wi-fi throughout
- 72 loading docks
- Exhibit halls with drive-on acces
- 3 beautifully landscaped outdoor plazas ideal for events

BUILDING LEGEND

-  First Aid Station
-  Building Directory
-  Women's Restroom
-  Men's Restroom
-  Escalator
-  Food Service
-  Elevator
-  ATM



Building **A** Level One

Exhibit Halls

Exhibit Halls A1, A2, A3

3 Meeting Rooms A101 – A103

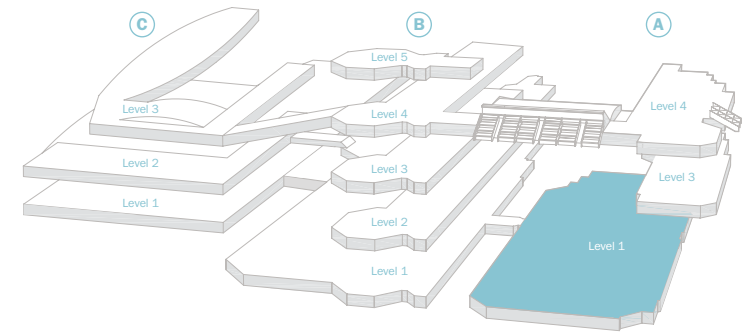

A1

- 149,000 square feet
- Ceiling height 30' to the bottom of the grid
- Dropped ceiling height 16'
- Floor boxes are on 30' centers
- Columns are on 90' centers
- Big columns are 10.5' x 12'
- Lights in this hall can be turned off individually without lift required
- Floor load 350 lbs. per square foot – slab on grade
- Docks 1–5

Overhead Doors

A1e 22'w x 25'10"h

A1g 18'w x 16'7"h

A1i 28'10"w x 15'5"h

Entrance Access Doors

A1a 18'w x 16'h

A2

- 86,000 square feet
- Ceiling height 30' to the bottom of the grid
- Dropped ceiling height 16'
- Floor boxes are on 30' centers
- Columns are on 90' centers
- Lights in this hall can be turned off individually without lift required
- Floor load 350 lbs. per square foot – slab on grade
- Docks 6–10

Overhead Doors

A2b 28'9"w x 15'4"h

Entrance Access Doors

A2a 18'w x 16'h

A2c 18'w x 16'h

A3

- 105,000 square feet
- Ceiling height 30' to the bottom of the grid
- Dropped ceiling height 16'
- Floor boxes are on 30' centers
- Columns are on 90' centers and 180' centers
- Lights in this hall can be turned off individually without lift required
- Floor load 350 lbs. per square foot – slab on grade
- Docks 11–15

Overhead Doors

A3b 22'8"w x 16'2"h

A3d 22'10"w x 25'10"h

A3e 14'5"w x 15'10"h

Entrance Access Doors

A3a 18'w x 16'h

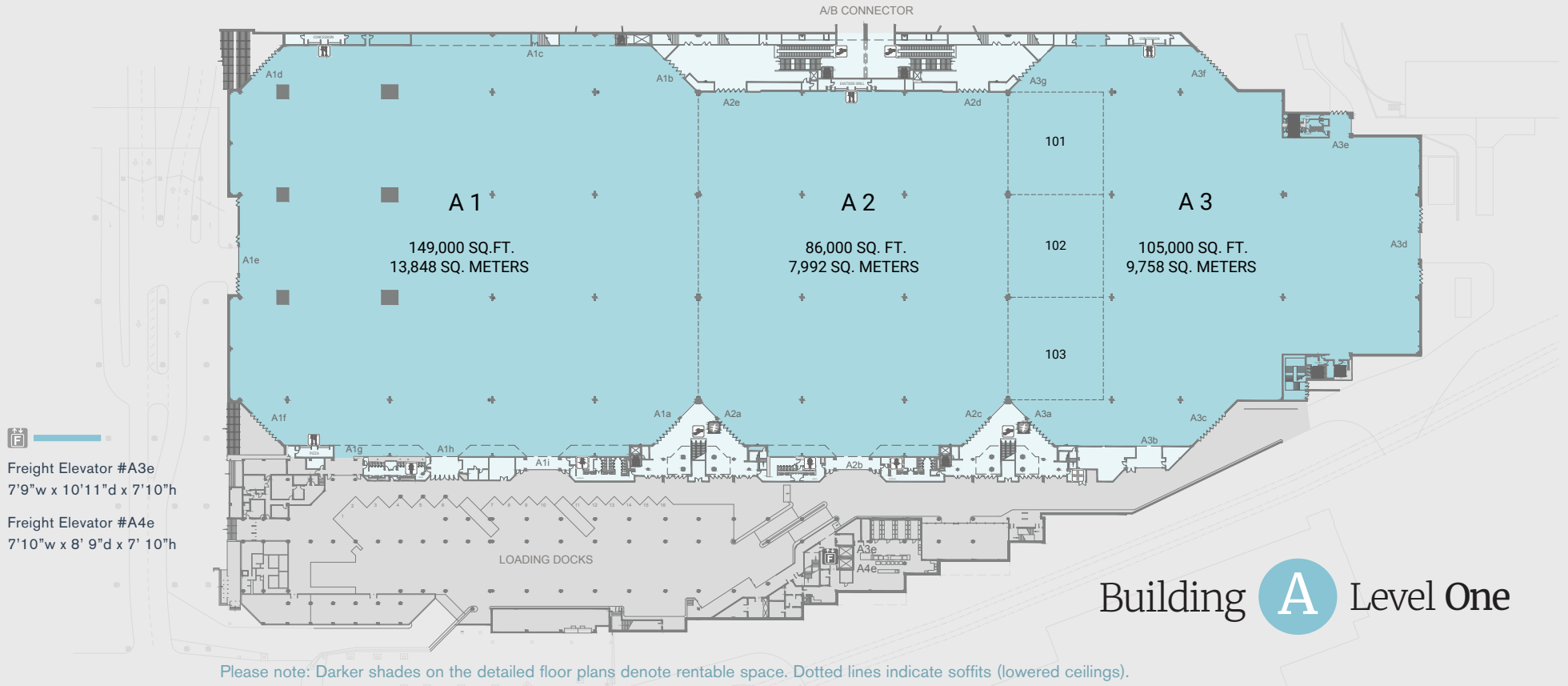

Exhibit Halls

Room or Area	Theater Capacity	10x10 Booths Capacity	Banquet Capacity	Usable Area		Ceiling Height
				Sq. Ft.	Sq. Meters	
Exhibit Hall A1	15,113	800	8,940	149,000	13,848	30'
Exhibit Hall A2	10,244	490	5,620	86,000	7,992	30'
Exhibit Hall A3	9,570	574	5,340	105,000	9,758	30'
A1 – A3	34,927	1,864	19,900	340,000	31,598	30'
A1 – A2	25,357	1,290	14,560	235,000	21,840	30'
A2 – A3	19,814	1,064	10,960	191,000	17,750	30'
A/B Connector				30,153		

Note: *Only available if halls A1 and A2 are not divided.

Meeting Rooms*

Room or Area	Theater Capacity	Theater Comfort Set	Classroom Capacity	Banquet Capacity	Usable Area		Ceiling Height
					Sq. Ft.	Sq. Meters	
A101	1,090	756	635	630	7,667	713	30'
A102	1,090	756	635	630	7,667	713	30'
A103	1,090	756	635	630	7,667	713	30'
A101 – A103	3,096	2,598	1,504	1,920	23,079	2,146	30'

Building **A** Level Three Concourse

17 Meeting Rooms A301 – A316

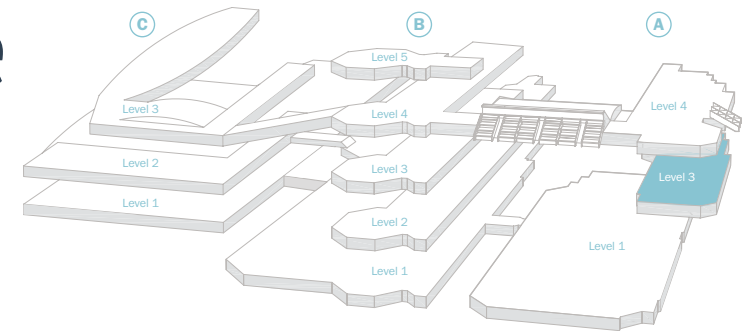

Room or Area	Theater Capacity	Theater Comfort Set	Classroom Capacity	Banquet Capacity	Usable Area		Ceiling Height
					Sq. Ft.	Sq. Meters	
A301	331	238	153	170	2,863	266.3	16'1"
A302	516	394	250	270	4,239	394.2	
A303	112	84	62	80	1,311	121.9	
A304	112	84	62	80	1,311	121.9	
A305	536	394	250	270	4,272	397.3	
A306	49		28	20	534	49.6	11'9"
A307	206	152	98	110	1,897	176.4	9'1"
A308a	49		24	20	454	42.2	8'6"
A308b	31		18	20	486	45.2	8'6"
A309	206	152	98	110	1,897	176.4	9'1"
A310	98	77	40	40	950	88.4	11'
A311	264	192	120	150	2,647	246.2	16'
A312	252	186	114	150	2,625	244.1	16'
A311 – A312	594	450	294	350	5,282	491.12	16'
A313	228	162	114	150	2,386	221.9	16'
A314	252	186	114	150	2,561	238.2	16'
A313 – A314	570	426	294	340	4,958	461.1	16'
A315	170	126	84	100	1,812	168.5	14'
A316	166	126	84	100	1,816	168.9	14'
A315 – A316	428	305	202	240	3,643	338.8	14'

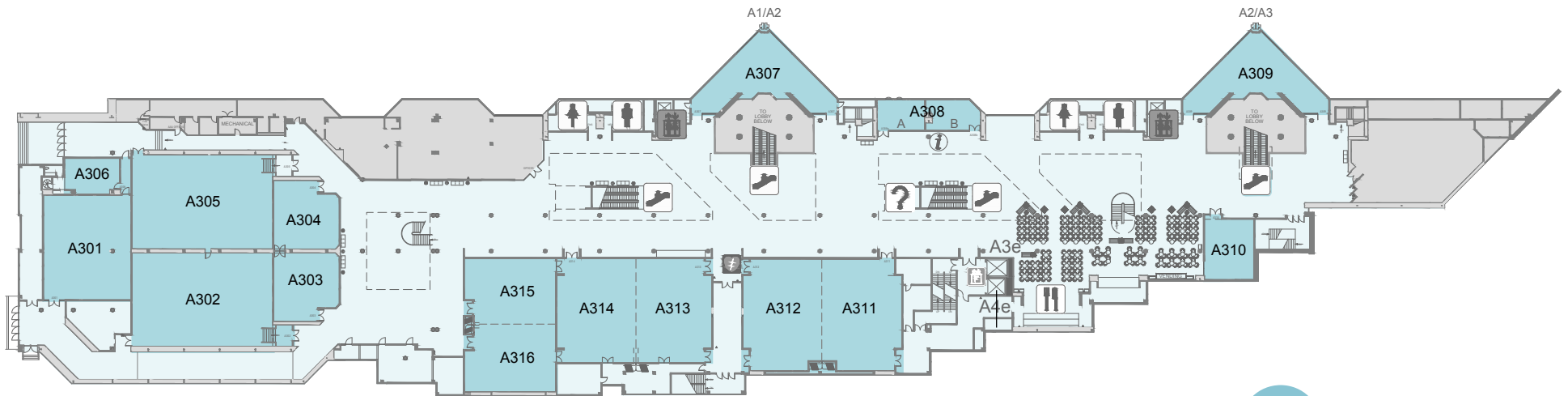

Building **A** Level Three

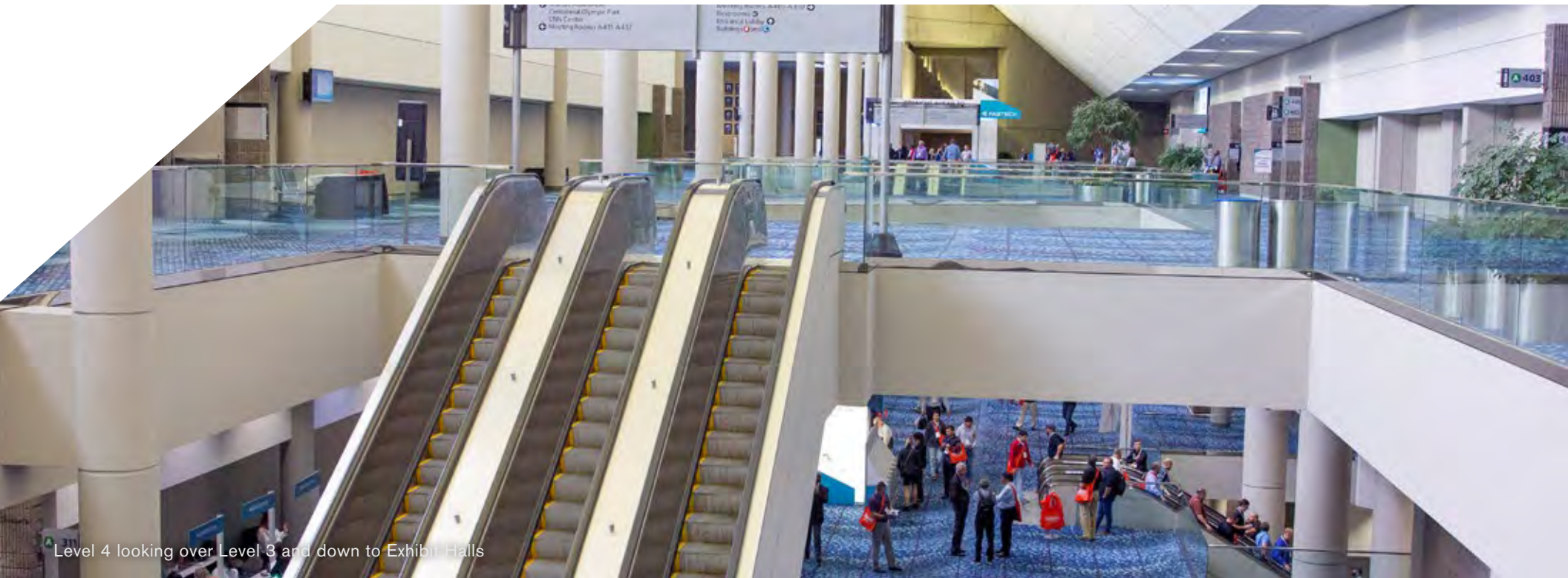

Level 4 looking over Level 3 and down to Exhibit Halls

Building **A** Level Four Concourse

Sidney Marcus Auditorium
Executive Boardroom

12 Meeting Rooms A401 – A412

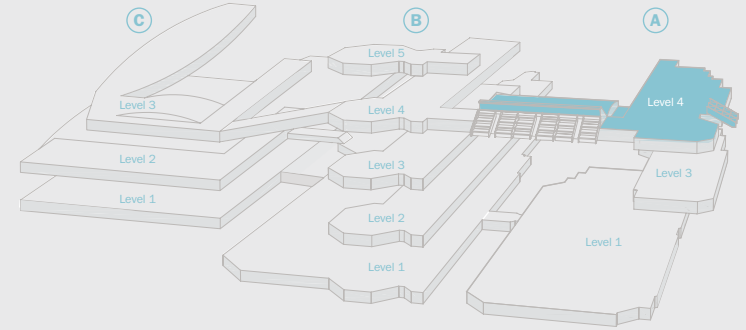

Room or Area	Theater Capacity	Theater Comfort Set	Classroom Capacity	Banquet Capacity	Usable Area		Ceiling Height
					Sq. Ft.	Sq. Meters	
Sidney Marcus Auditorium							
Sidney Marcus Auditorium	1,726 seats + 18 wheelchair spaces				15,689		28' to 50'
SMA Foyer Space					5,283		
Executive Boardroom							
Executive Boardroom			34	34	2,593		
Meeting Rooms							
A401	106	80	51	60	1,220	113.3	16'2"
A402	172	139	101	90	1,898	176.5	16'2"
A403	172	139	101	90	1,901	176.8	16'2"
A402 – A403	406	330	218	240	3,779	351.4	16'2"
A404	210	156	115	90	2,058	191.4	14'9"
A405	210	156	115	90	2,048	190.5	14'9"
A404 – A405	490	366	244	280	4,096	380.9	14'9"
A406	109	82	47	40	1,143	106.3	16'
A407	124	98	76	60	1,411	131.2	16'
A406 – A407	276	206	153	170	2,553	237.4	16'
A408	136	102	80	60	1,492	143.5	14'10"
A409	69	57	34	30	785	72.46	13'7"
A410	381	285	189	180	3,331	309.8	16'
A411	633	515	345	400	5,834	542.6	17'3"
A411 – A412b	940	762	534	570	8,153	758.2	17'3"
A412a	300	239	188	190	3,169	294.7	17'3"
A412	685	500	318	340	5,488	510.4	17'3"
A411 – A412	1,360	1,192	747	780	11,291	1,050.1	17'3"
Registration Hall							
Registration Hall A					10,162		
Registration Hall A+B					20,324		

GEORGIA WORLD CONGRESS CENTER

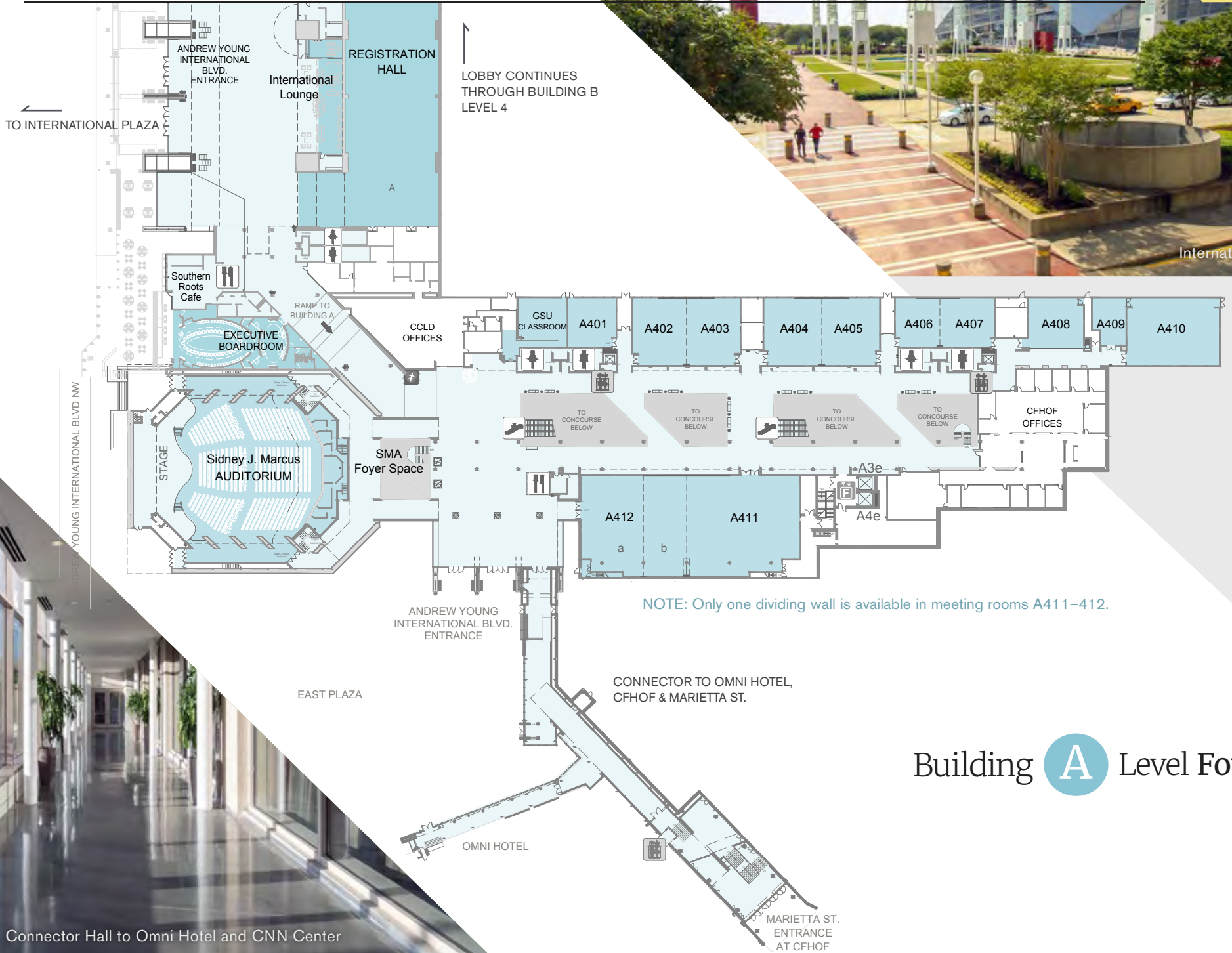

NOTE: Only one dividing wall is available in meeting rooms A411-412.

Building **A** Level Four



OMNI HOTEL

MARIETTA ST. ENTRANCE AT CFHOF

EAST PLAZA

ANDREW YOUNG INTERNATIONAL BLVD. ENTRANCE

CONNECTOR TO OMNI HOTEL, CFHOF & MARIETTA ST.

LOBBY CONTINUES THROUGH BUILDING B LEVEL 4

TO INTERNATIONAL PLAZA

ANDREW YOUNG INTERNATIONAL BLVD NW

Building **B** Level One

Exhibit Halls

Exhibit Halls B1, B2, B3, B4, B5

3 Meeting Rooms B101 – B103

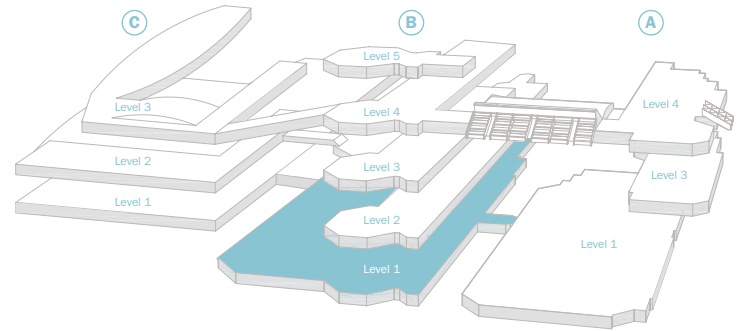

B1

- 89,500 square feet
- Ceiling height 30' to the bottom of the grid
- Dropped ceiling height 16'
- Floor boxes are on 30' centers
- Columns are on 90' centers and 180' centers
- Lights in this hall can be turned off individually without lift required
- Floor load 350 lbs. per square foot – slab on grade
- Docks 53–57

Overhead Doors

B1b 20'w x 16'h
B1c 24'w x 16'2"h
B1e 24w x 15'h

Entrance Access Doors

B1a 19'3"w x 9'11"h

B2

- 96,000 square feet
- Ceiling height 30' to the bottom of the grid
- Dropped ceiling height 16'
- Floor boxes are on 30' centers
- Columns are on 90' centers
- Lights in this hall can be turned off individually without lift required
- Floor load 350 lbs. per square foot – slab on grade
- Docks 45–52

Overhead Doors

B2e 19'11"w x 16'h
B2f 24'w x 16'h
B2g 20'w x 16'h

Entrance Access Doors

B2a 19'3"w x 9'11"h
B2d 19'3"w x 9'11"h

B3

- 121,500 square feet
- Ceiling height 30' to the bottom of the grid
- Dropped ceiling high 16'
- Floor boxes are on 30' centers
- Columns are on 90' centers
- Lights in this hall can be turned off individually without lift required
- Floor load 350 lbs. per square foot – slab on grade
- Docks 35–44

Overhead Doors

B3b 20'w x 10'9"h
B3d 18'w x 27'h
B3e 23'w x 16'h
B3f 19'10"w x 16'h

Entrance Access Doors

B3a 19'3"w x 9'11"
B3c 19'10"w x 9'11"h

B4

- 149,500 square feet
- Ceiling height 30' to the bottom of the grid
- Dropped ceiling height 16'
- Floor boxes are on 30' Centers
- Columns are on 90' centers and 180' centers
- Lights in this hall can be turned off individually without lift required
- Floor load 350 lbs. per square foot – slab on grade

Overhead Doors

B4c 14'w x 16'h
B4e 19'9"w x 15'7"h
B4f 24'w x 15'7"h
B4g 24'w x 15'7"h

Entrance Access Doors

B4a 19'10"w x 9'11"
B4d 19'10"w x 9'11"

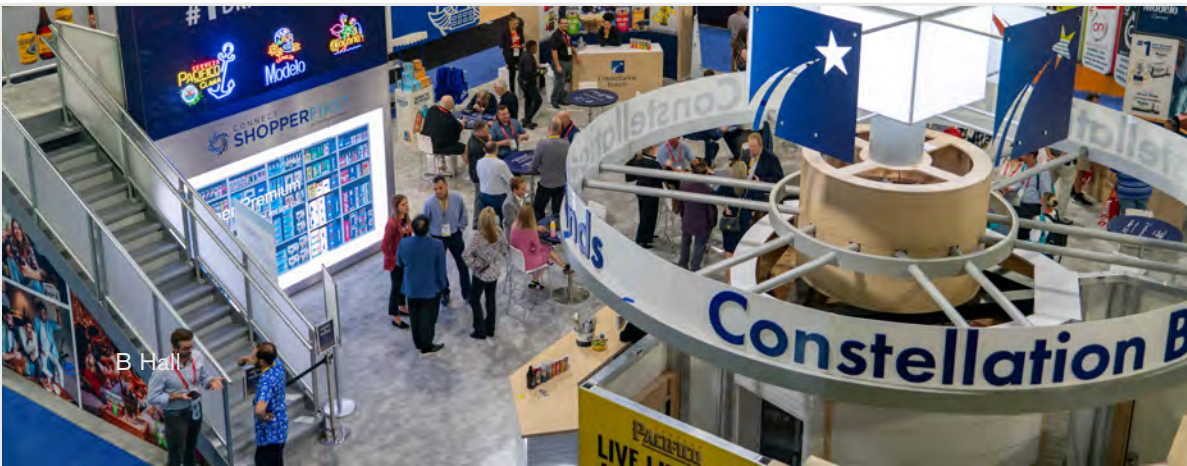

Building **B** Level One

- F** Freight Elevator #1
9'5" w x 21'5" d x 9'5" h
- Freight Elevator #3
47" w x 11'11" d x 7" h
- Freight Elevator #6
9'9" w x 18' d x 8' h
- Freight Elevator #7
9'9" w x 21'6" d x 8' h
- Freight Elevator #13
9'9" w x 17' d x 8'6" h

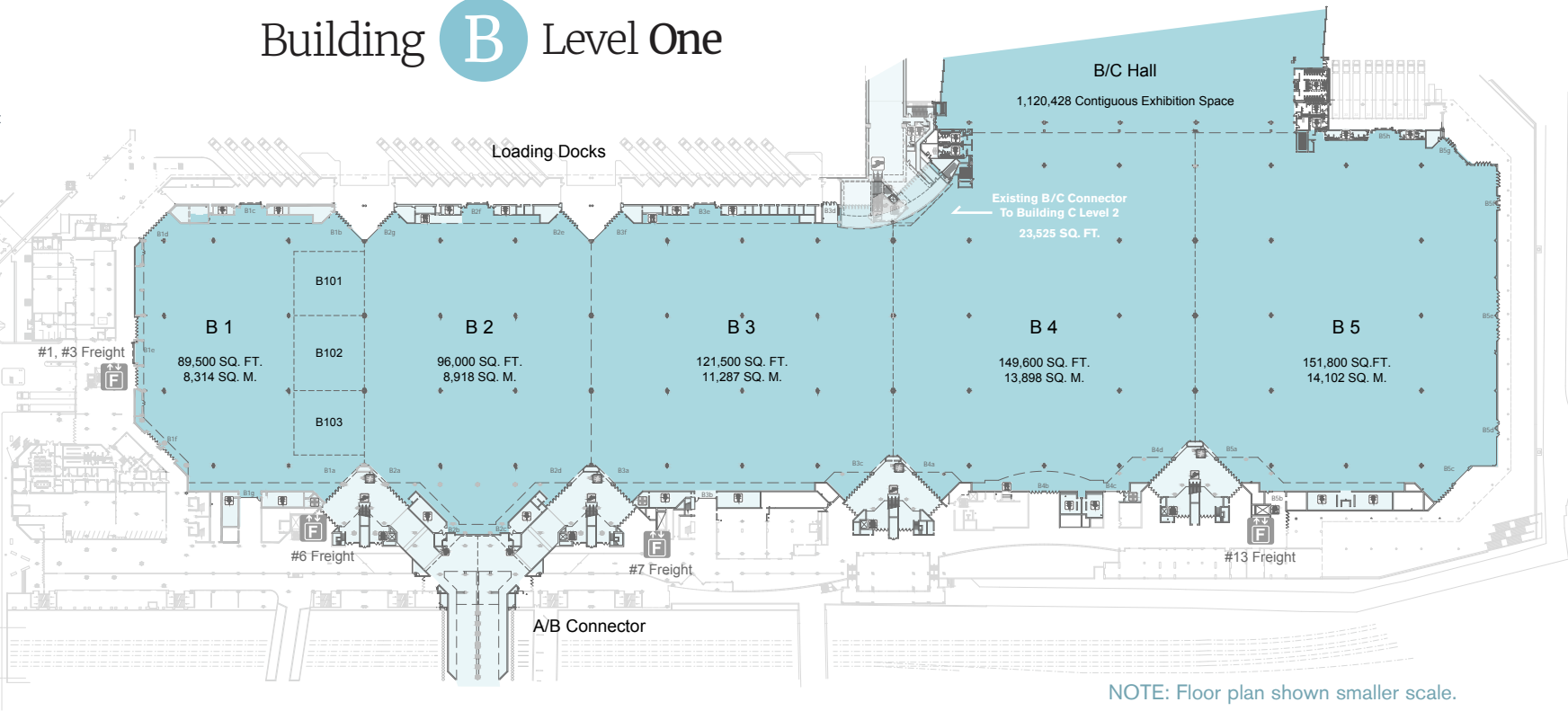

NOTE: Floor plan shown smaller scale.

B5

- 151,000 square feet
- Ceiling height 30' to the bottom of the grid
- Dropped ceiling height 16'
- Floor boxes are on 30' centers
- Columns are on 90' centers and 180' centers
- Lights in this hall can be turned off individually without lift required
- Floor load 350 lbs. per square foot – slab on grade
- Docks 26-34

- Overhead Doors**
- B5b 14' w x 16' h
 - B5c 22' w x 15'7" h
 - B5g 21'3" w x 15'7" h
 - B5h 24' w x 15'7" h
 - B5i 24' w x 15'7" h
 - B5j 19'9" w x 15'7" h
- Entrance Access Doors**
- B5a 19'10" w x 9'11" h

Room or Area	Theater Capacity	10x10 Booths Capacity	Banquet Capacity	Usable Area		Ceiling Height	
				Sq. Ft.	Sq. Meters		
Exhibit Halls							
Exhibit Hall B1	8,606	468	4,760	89,500	8,318	30'	
Exhibit Hall B2	9,908	514	5,480	96,000	8,922	30'	
Exhibit Hall B3	13,254	681	7,980	121,500	11,292	30'	
Exhibit Hall B4	15,870	805	9,310	149,500	13,894	30'	
Exhibit Hall B5	15,984	837	9,370	151,000	14,033	30'	
B1 – B5	63,622	3,305	36,900	607,500	56,459	30'	
B – B/C Hall – C	110,882	5,864	65,620	1,120,428	102,134	30'	
B/C Hall	10,000	390	4,940	97,678	9,087		
A/B Connector				30,153			
Meeting Rooms							
Room or Area	Theater	Theater Comfort Set	Classroom	Banquet	Sq. Ft.	Sq. Meters	Ceiling
B101	1,050	630	555	550	6,435	598.4	30'
B102	1,090	756	635	630	7,513	698.7	30'
B103	1,050	756	555	550	6,435	598.4	30'
B101 – B103	2,808	2,343	1,376	1,760	20,425	1,899.5	30'

Building B Level Two Concourse

18 Meeting Rooms B201 – B218

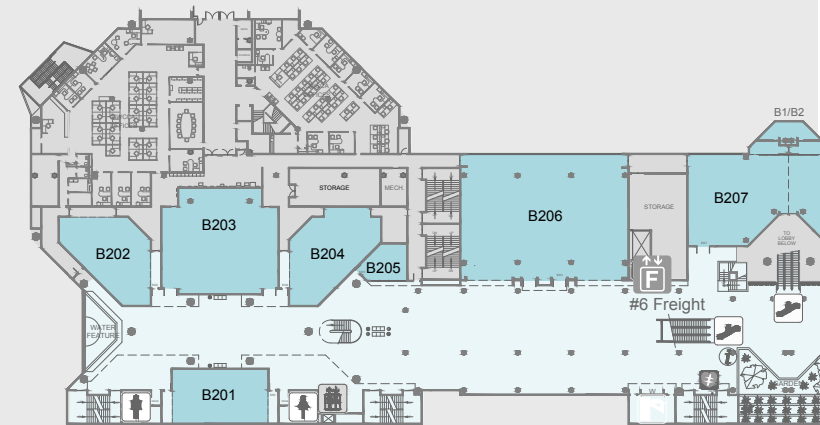
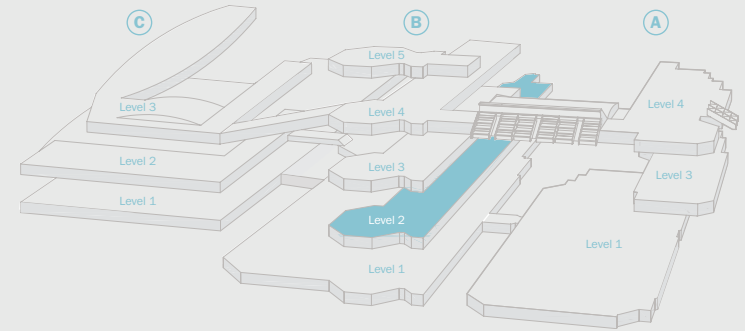

Room or Area	Theater Capacity	Theater Comfort Set	Classroom Capacity	Banquet Capacity	Usable Area		Ceiling Height
					Sq. Ft.	Sq. Meters	
B201	202	146	92	100	1,857	172.7	14'6"
B202	198	144	109	110	2,113	196.5	14'6"
B203	390	390	200	220	3,645	338.9	15'2"
B204	198	144	109	110	2,109	196.1	14'6"
B205	48		21	20	471	43.8	8'6"
B206	740	544	376	420	6,638	617.3	15'2"
B207	291	223	146	160	2,799	260.3	14'6"
B208	291	223	146	160	2,803	260.7	14'6"
B207 – B208	644	464	326	340	5,292	492.2	14'6"
B209	164	119	75	80	1,572	146.2	13'10"
B210	164	119	75	80	1,564	145.5	13'10"
B211	293	223	146	160	2,803	260.7	14'6"
B212	293	293	146	160	2,803	260.7	14'6"
B211 – B212	644	464	326	340	5,292	492.5	14'6"
B213	270	197	123	160	2,617	243.4	14'6"
B214	270	197	123	160	2,616	243.3	14'6"
B213 – B214	582	408	262	350	5,184	482.1	14'6"
B215	233	170	117	110	2,070	192.5	13'10"
B216	270	223	123	160	2,607	242.5	14'6"
B217	270	197	123	160	2,607	242.5	14'6"
B216 – B217	582	408	262	350	5,169	480.7	14'6"
B218	234	170	117	110	2,075	193.0	13'10"
Maple Point					2,667		
Willow Garden					3,189		



Building **B** Level Two

Building B- Willow Garden

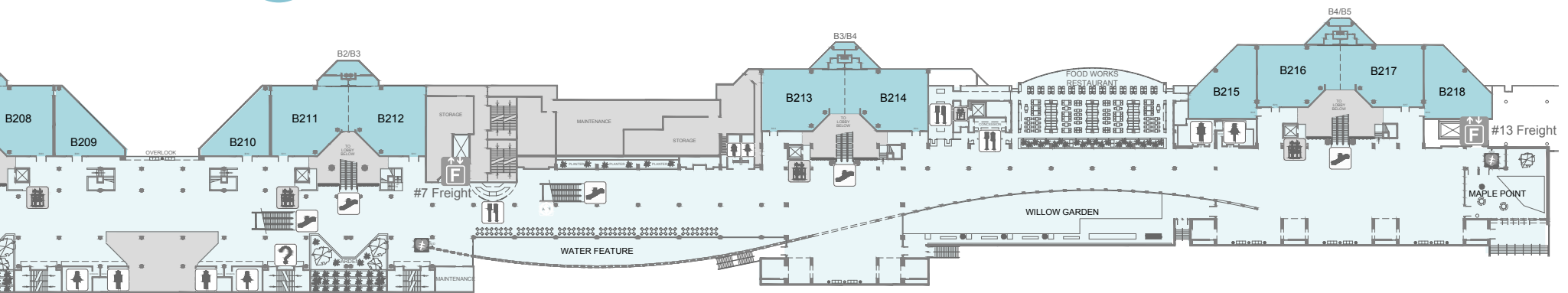

NOTE: Floor plan shown smaller scale.

Building B Level Three Concourse

19 Meeting Rooms
B301 – B319

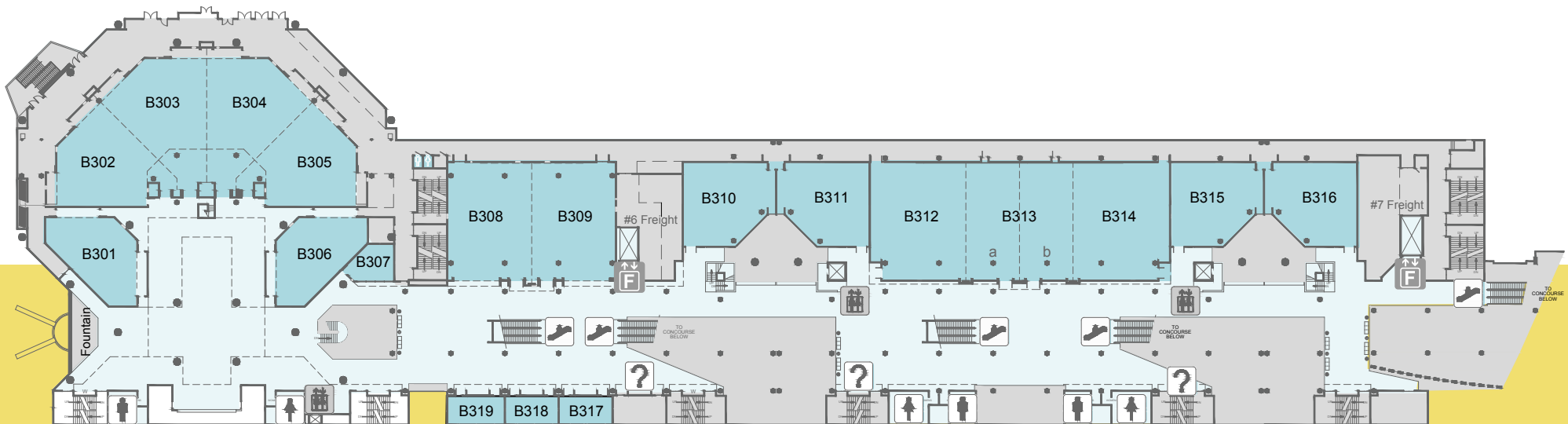
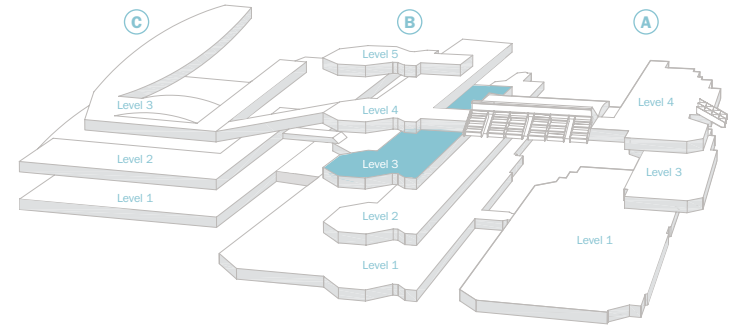

NOTE: Only two dividing walls are available in meeting rooms B312–B314.

Room or Area	Theater Capacity	Theater Comport Set	Classroom Capacity	Banquet Capacity	Usable Area		Ceiling Height
					Sq. Ft.	Sq. Meters	
B301	198	144	109	110	2,120	197.2	14'6"
B302	286	212	128	150	2,773	257.9	20'
B303	314	239	136	170	3,115	289.7	20'
B304	314	239	136	170	3,115	289.7	20'
B305	286	212	128	150	2,733	257.9	20'
B302 – B303	611	447	323	310	5,900	548.7	20'
B302 – B304	1,036	721	520	550	9,028	839.6	20'
B303 – B304	652	464	324	360	6,243	580.6	20'
B304 – B305	611	447	323	310	5,900	548.7	20'
B302 – B305	1,340	958	684	680	11,795	1,096.9	20'
B306	198	144	109	110	2,120	197.2	14'6"
B307	50		21	20	471	43.8	8'6"
B308	332	247	164	180	3,111	289.3	15'10"
B309	332	247	164	180	3,105	288.3	15'10"
B308 – B309	740	544	376	420	6,171	573.9	15'10"
B310	212	186	108	130	2,178	202.5	14'6"
B311	212	186	108	130	2,178	202.5	14'6"
B312	408	290	210	220	3,476	323.3	15'10"
B313a	218	163	107	110	1,996	185.6	15'10"
B313b	218	163	107	110	1,994	185.4	15'10"
B313	470	331	232	250	4,002	372.2	15'10"
B314	422	290	210	230	3,514	326.8	15'10"
B312 – B313a	691	479	337	390	5,484	510.0	15'10"
B312 – B313	946	693	482	560	7,490	696.6	15'10"
B313b – B314	691	479	482	390	5,484	513.3	15'10"
B313 – B314	946	639	482	560	7,490	700.1	20'
B312 – B314'	1,368	1,003	710	780	11,016	1,024.5	15'10"
*NOTE: Only two dividing walls are available in meeting rooms B312 – B314.							
B315	212	186	108	130	2,178	202.5	14'6"
B316	212	186	108	130	2,178	202.5	14'6"
B317	49		24	20	462	43.0	8'6"
B318	49		24	20	458	42.6	8'6"
B319	49		24	20	479	44.5	8'6"



Building B Level Four Concourse

10 Meeting Rooms B401 – B411

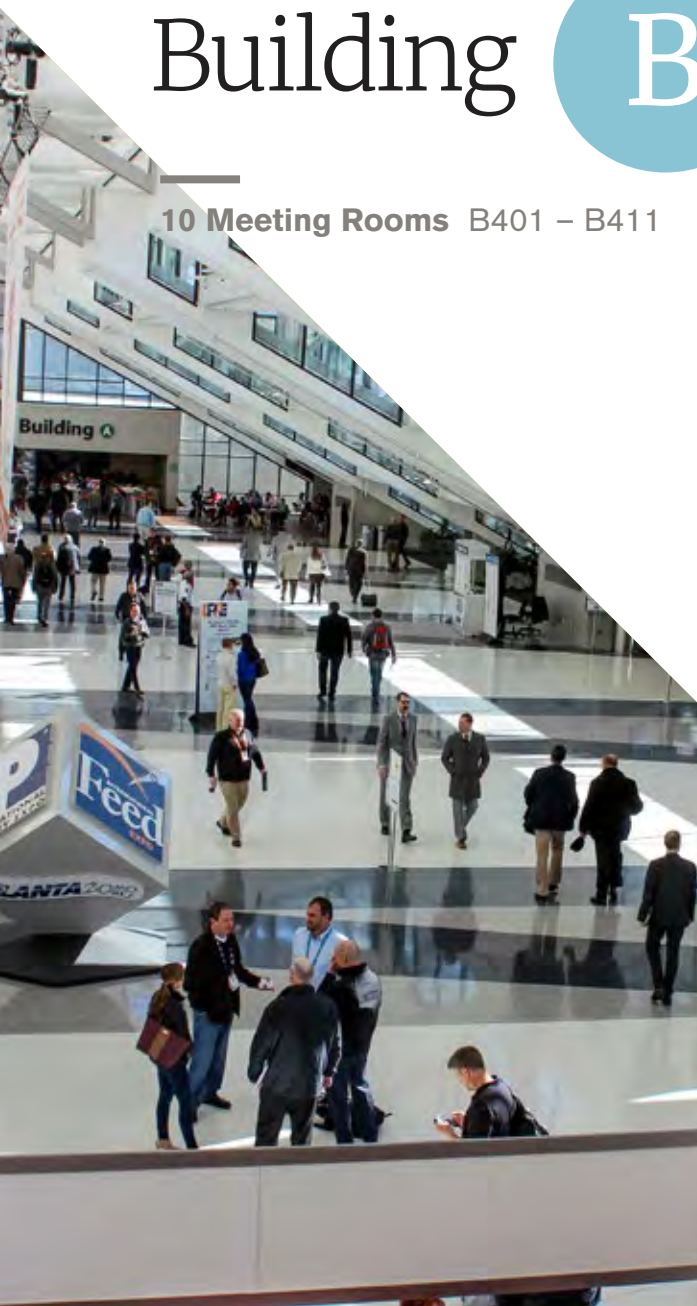
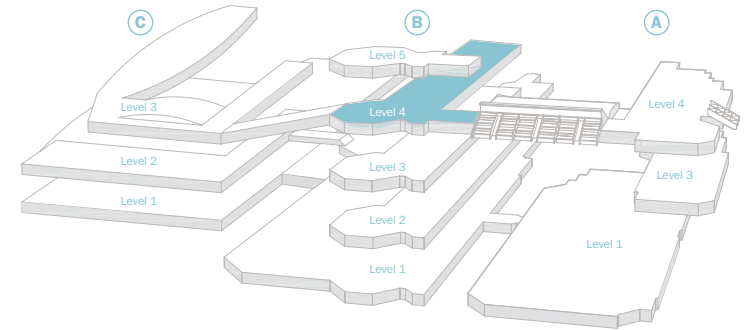

Room or Area	Theater Capacity	Theater Comfort Set	Classroom Capacity	Banquet Capacity	Usable Area		Ceiling Height
					Sq. Ft.	Sq. Meters	
B401	332	247	164	180	3,111	289.3	15'10"
B402	332	247	164	180	3,105	288.8	15'10"
B401 – B402	740	544	376	420	6,171	573.9	15'10"
B403	212	186	108	130	2,182	202.9	14'6"
B404	212	186	108	130	2,182	202.9	14'6"
B405	408	290	210	220	3,476	323.3	15'10"
B406a	218	163	107	110	1,996	185.6	15'10"
B406b	218	163	107	110	1,994	185.4	15'10"
B406	470		232	250	4,002	372.2	15'10"
B407	422	290	210	230	3,514	326.8	15'10"
B405 – B406a	691	479	337	390	5,484	510	15'10"
B405 – B406	946	693	480	560	7,490	696.6	15'10"
B406b – B407	691	479	482	390	5,484	513.3	15'10"
B406 – B407	946	693	480	560	7,490	696.6	15'10"
B405 – B407	1,368	1,003	710	780	11,016	1,024.5	15'10"
NOTE: Only two dividing walls are available in meeting rooms B405–B407.							
B408	212	186	108	130	2,178	202.5	14'6"
B409	212	186	108	130	2,178	202.5	14'6"
B411	28		12	20	465	42.7	8'6"
Registration Hall B					10,162		
Registration Hall A+B					20,324		
International Plaza*					106,824		
NOTE: as seen on page 2							

IPPE attendees in A/B Lobby



Social Table

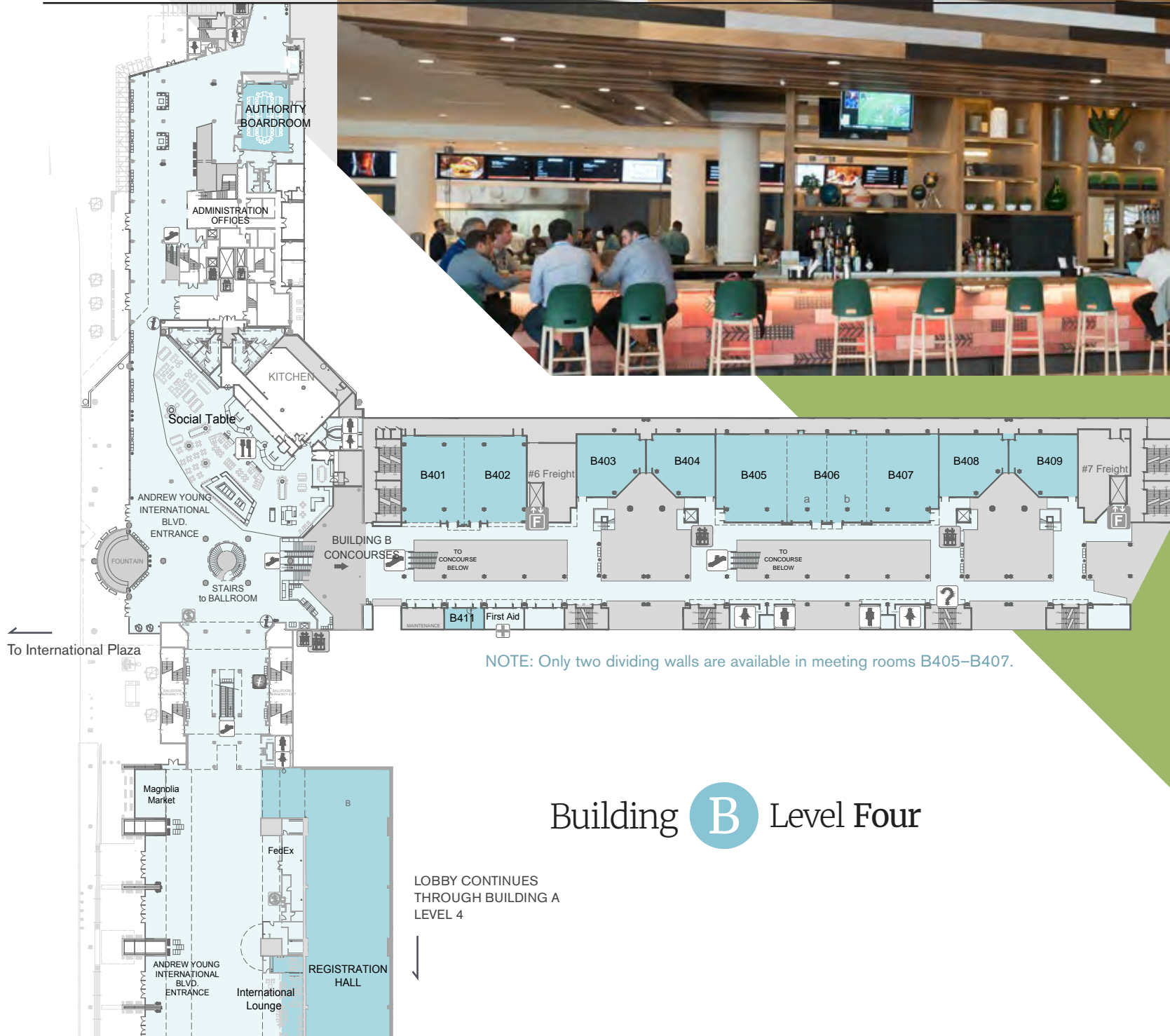

NOTE: Only two dividing walls are available in meeting rooms B405-B407.

Building **B** Level Four

LOBBY CONTINUES THROUGH BUILDING A LEVEL 4



Building B Level Five Ballroom

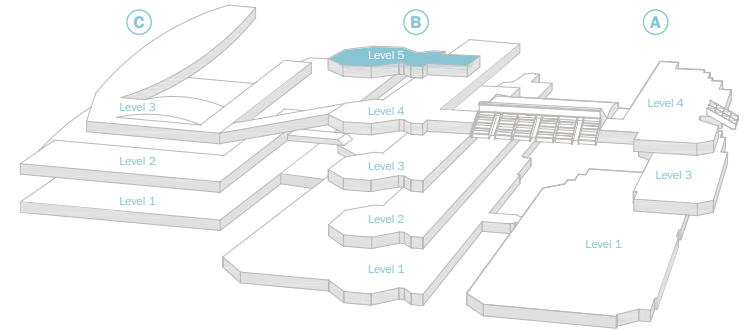

Thomas Murphy Ballroom Sections 1 – 4

Room or Area	Theater Capacity	Classroom Capacity	Banquet Capacity	Usable Area		Ceiling Height
				Sq. Ft.	Sq. Meters	
Thomas Murphy Ballroom Building B – Sections 1-4	3,634	1,856	2,100	33,000	3,069	27'-37'
Thomas Murphy Ballroom Building B – Sections 1-3 or 2-4	2,742	1,400	1,600	24,740	2,300	27'-37'
Thomas Murphy Ballroom Building B – Sections 1-2 or 3-4'	1,654	888	950	16,000	1,534	27'-37'
Thomas Murphy Ballroom Building B – Sections 2-3'	1,772	1,120	1,280	16,500	1,534	27'-37'
Thomas Murphy Ballroom Building B – Section 1 or 4'	627	288	430	8,260	768	27'-37'
Stage				2,000		
Galleria				18,000		

*NOTE: Only enough panels are available to complete two dividing walls at any given time in the Thomas Murphy Ballroom.

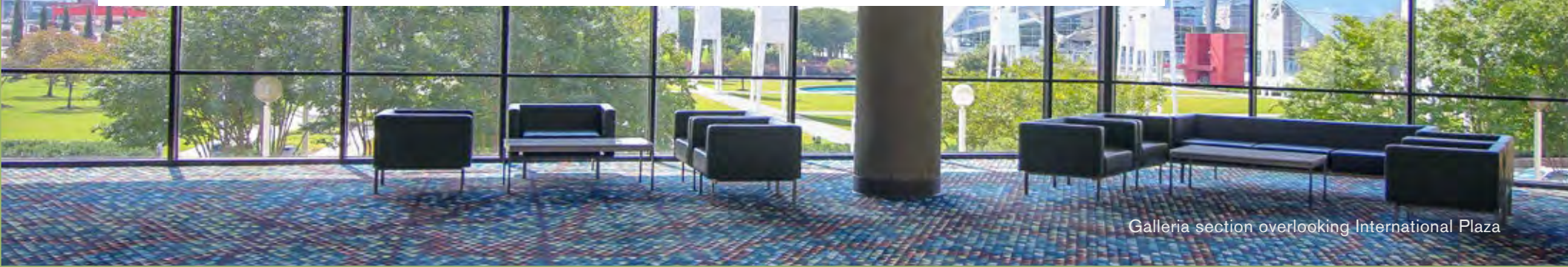
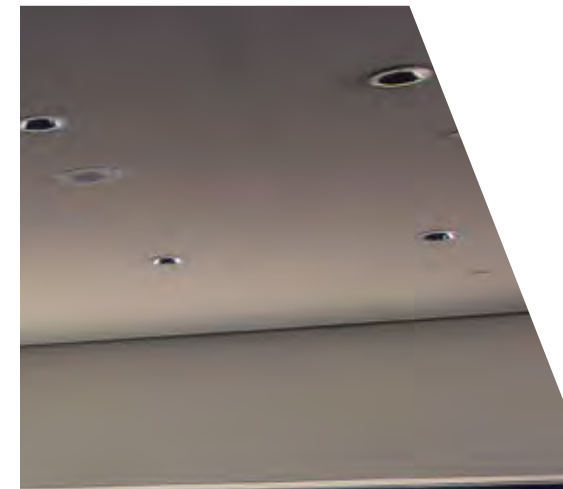

Galleria section overlooking International Plaza

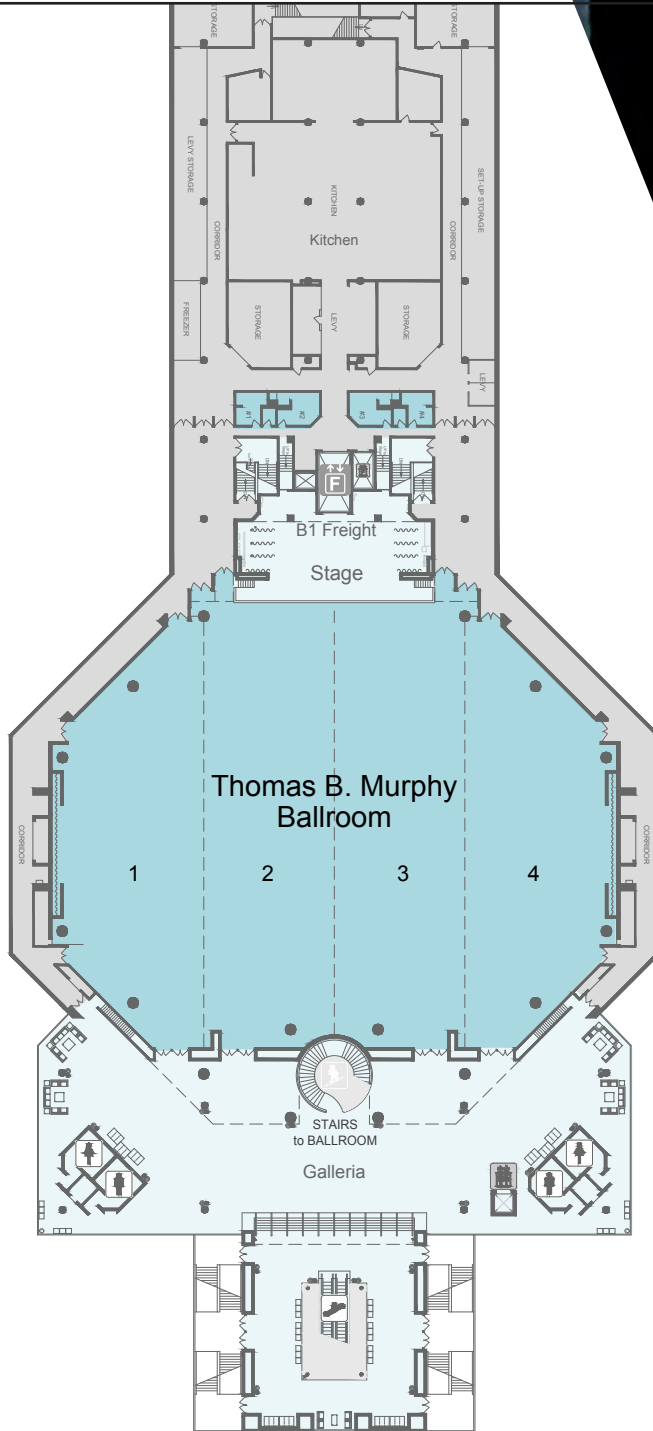

 Thomas B. Murphy Ballroom
Freight Dimension
20'5" w x 8'4" h



Thomas B. Murphy Ballroom

Building **B/C** Level One

Exhibit Halls B1 – B5

B/C Hall

Exhibit Halls C1 – C4

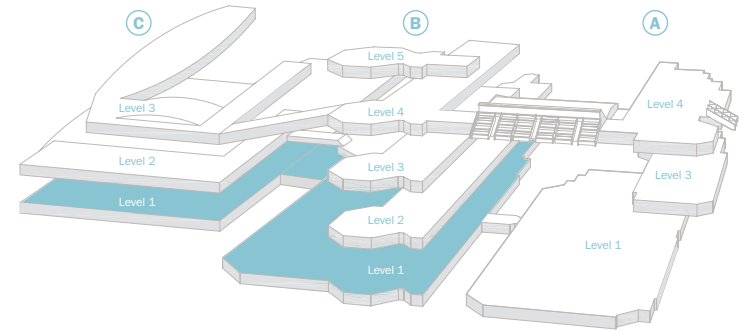

C Hall to B/C Hall

B/C Hall

- 97,678 square feet
- Ceiling height 30' to the bottom of the grid
- Dropped ceiling height 16'
- Floor boxes are on 30' centers
- Columns are on 90' centers and 160' centers
- Lights in this hall can be turned off individually without lift required
- Floor load 400 lbs. per square foot – slab on grade

Overhead Doors

- Hangar door south 50'w x 16'h
- Hangar door north 60'w x 25'h
- New C4D Dock door 24'w x 16'h
- Ramp width south 74'w
- Ramp width north 75'-5" w

-  Freight Elevator #1
9'5" w x 21'5" d x 9'5" t
- Freight Elevator #3
47' w x 11'11" d x 7' h
- Freight Elevator #6
9'9" w x 18' d x 8' h
- Freight Elevator #7
9'9" w x 21'6" d x 8' h
- Freight Elevator #13
9'9" w x 17' d x 8'6" h

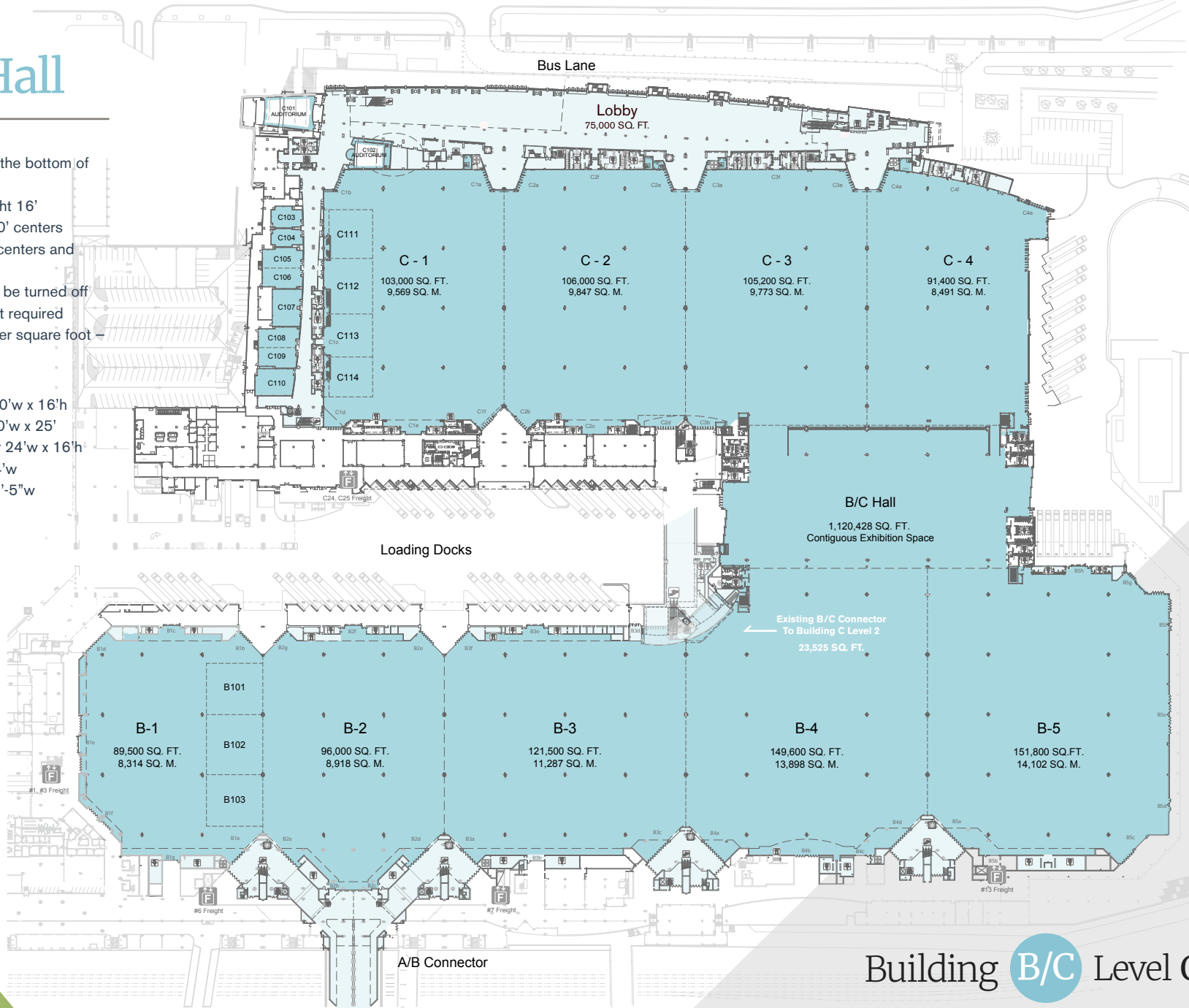

Building C Level One

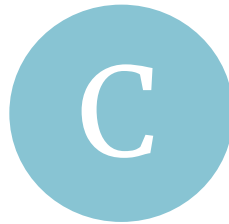

Concourse and Exhibit Halls

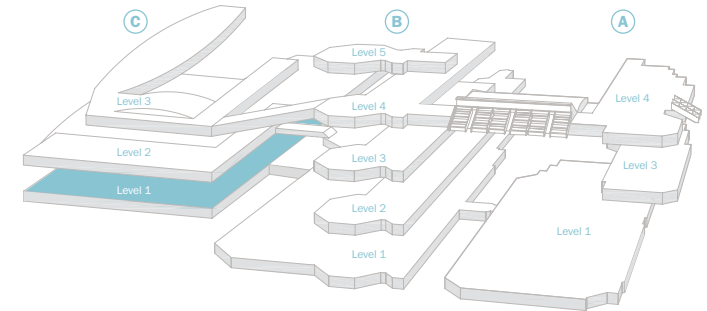

Exhibit Halls C1 – C4
8 Meeting Rooms C103 – C110
2 Auditoriums



Trade Show Set

Room or Area	Theater Capacity	Theater Comfort Set	10x10 Booths Capacity	Banquet Capacity	Usable Area		Ceiling Height
					Sq. Ft.	Sq. Meters	
Exhibit Halls							
Exhibit Hall C1	9,264		538	6,100	103,250	9,569	30'
Exhibit Hall C2	9,264		558	6,100	106,000	9,858	30'
Exhibit Hall C3	10,320		556	6,090	105,500	9,801	30'
Exhibit Hall C4	7,755		477	5,061	91,100	8,463	30'
Exhibit Hall C1 – C4	36,603		2,129	23,351	405,850	37,704	30'
B/C Hall	10,000		390	4,940	85,300	7,924	
B – B/C Hall – C	110,882		5,864	65,620	1,099,200	102,119	30'
Room or Area	Theater		Classroom	Banquet	Sq. Ft.	Sq. Meters	Ceiling
Meeting Rooms							
C101 Auditorium	396				5,163		13' 10" to 20' 3"
C102 Auditorium	225				2,420		13' 5" to 17' 6"
C103	144	107	66	60	1,360	126.8	16'
C104	117	87	54	50	1,164	108.3	16'
C105	194	143	93	80	1,781	165.6	16'
C106	196	148	95	80	1,779	165.4	16'
C105 – C106	418	317	207	220	3,560	331.1	16'
C107	247	187	120	140	2,391	222.3	16'
C108	202	148	95	90	1,783	165.8	16'
C109	190	142	88	80	1,719	159.9	16'
C108 – C109	405	297	208	210	3,502	325.7	16'
C110	270	198	139	130	2,328	216.5	16'
C111	706/660*	483	290	330	5,138	477.32	30'
C112	803/771*	561	334	380	5,833	541.89	30'
C113	632/567*	417	254	320	4,622	429.38	30'
C114	516/460*	348	244	250	4,138	384.42	30'
C111 – C112	1,410/1,316*	980	648	840	10,971	1,019	30'
C111 – C113	2,100/1,904*	1,400	960	1,200	15,604	1,499	30'
C111 – C114	2,628/2,408*	1,792	1,200	1,560	19,742	1,834	30'
C112 – C113	1,380/1,247*	942	624	780	10,466	972	30'
C112 – C114	1,764/1,764*	1,316	888	1,140	14,604	1,356	30'
C113 – C114	1,110/1,008*	756	504	660	8,771	814	30'
C Lobby					98,372		

* Exhibit Hall Chair / Meeting Room Chair

Building C Level One

B/C Hall

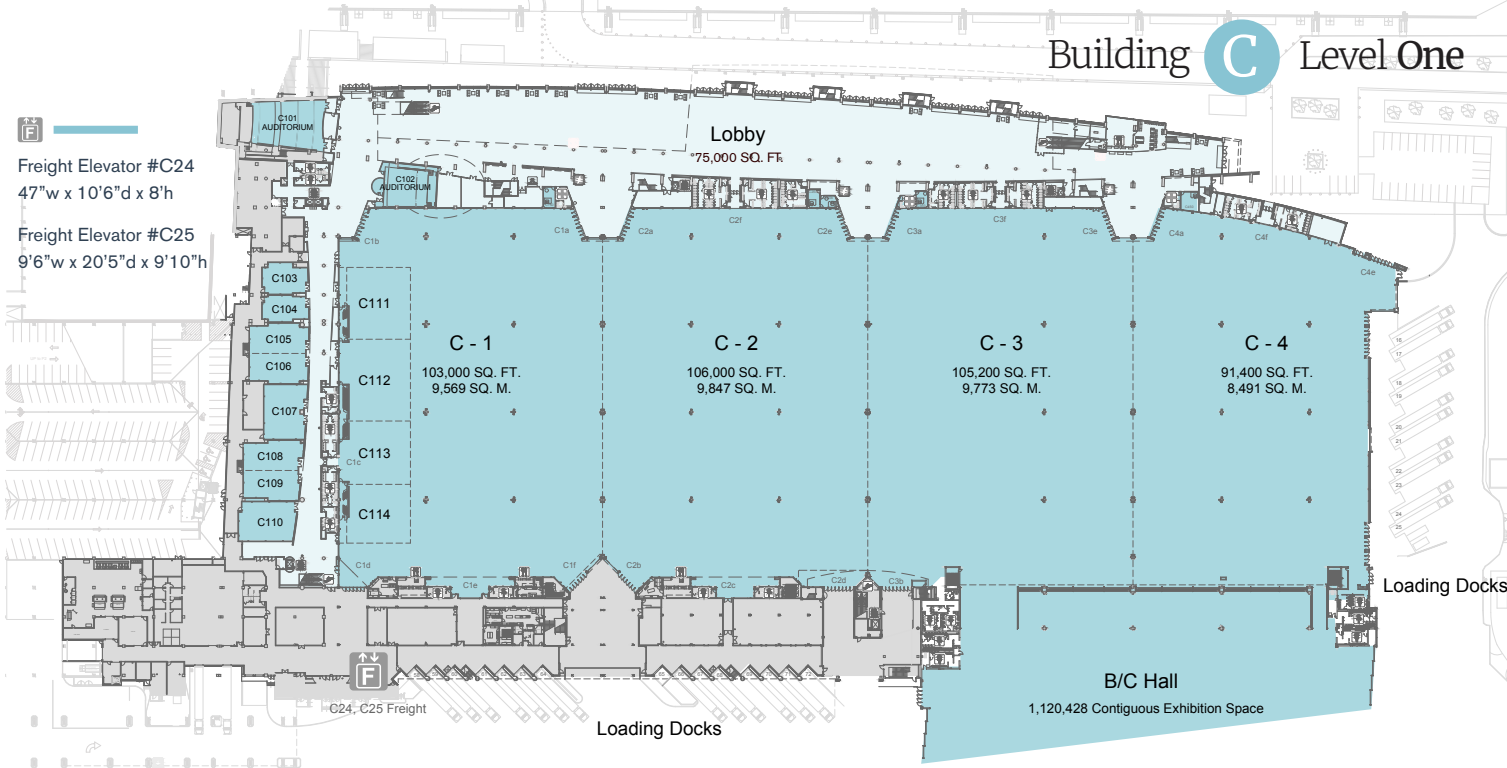

- 97,678 square feet
- 1,120,428 total square feet for all halls
- Ceiling height 30' to the bottom of the grid
- Dropped ceiling height 16'
- Floor boxes are on 30' centers
- Columns are on 90' centers and 160' centers
- Lights in this hall can be turned off individually without lift required
- Floor load 400 lbs. per square foot – slab on grade

Overhead Doors

- Hangar door south 50'w x 16'h
- Hangar door north 60'w x 25'h
- New C4D dock door 24'w x 16'h
- Ramp width south 74'w
- Ramp width north 75'-5" w

C1

- 103,250 square feet
- Ceiling height 30' to the bottom of the grid
- Dropped ceiling height 16'
- Floor boxes are on 30' centers
- Columns are on 90' centers
- Lights in this hall can be turned off individually without lift required
- Floor load 400 lbs. per square foot – slab on grade
- Docks 58–64
- 1 Office

Overhead Doors

C1f 19'3"w x 16'h

Entrance Access Doors

C1a 12'9"w x 21'6"h

C1b 12'9"w x 21'6"h

C1d 12'9"w x 21'6"h

C2

- 106,000 square feet
- Ceiling height 30' to the bottom of the grid
- Dropped ceiling height 16'
- Floor boxes are on 30' centers
- Columns are on 90' centers
- Lights in this hall can be turned off individually without lift required
- Floor load 400 lbs. per square foot – slab on grade
- Docks 65–72
- 2 Offices

Overhead Doors

C2b 19'3"w x 16'h

Entrance Access Doors

C2a 12'9"w x 21'6"h

C2e 12'9"w x 21'6"h

C3

- 106,000 square feet
- Ceiling height 30' to the bottom of the grid
- Dropped ceiling height 16'
- Floor boxes are on 30' centers
- Columns are on 90' centers
- Lights in this hall can be turned off individually without lift required
- Floor load 400 lbs. per square foot – slab on grade
- 1 Office

Overhead Doors

C3c 20'w x 16'h

C3d 19'3"w x 16'h

Entrance Access Doors

C3a 12'9"w x 21'6"h

C3e 12'9"w x 21'6"h

C4

- 100,000 square feet
- Ceiling height 30' to the bottom of the grid
- Dropped ceiling high 16'
- Floor boxes are on 30' centers
- Columns are on 90' centers
- Lights in this hall can be turned off individually without lift required
- Floor load 400 lbs. per square foot – slab on grade
- Docks 16–25
- 1 Office

Overhead Doors

C4b 19'3"w x 16'h

C4c 20'w x 16'h

C4d 24'w x 27'h

Entrance Access Doors

C4a 12'9"w x 21'6"h

Building C Level Two Concourse

13 Meeting Rooms C201 – C213

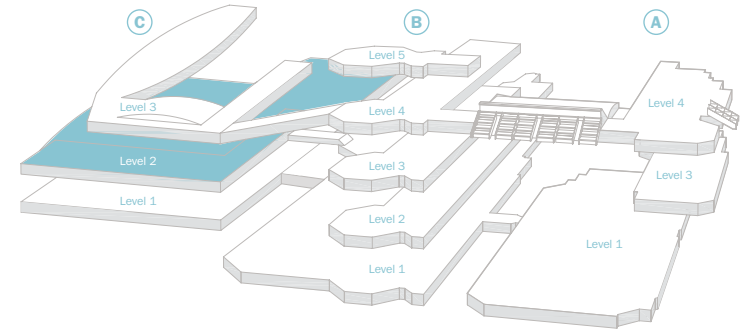

Room or Area	Theater Capacity	Theater Comfort Set	Classroom Capacity	Banquet Capacity	Usable Area		Ceiling Height
					Sq. Ft.	Sq. Meters	
C201	251	185	135	120	2,342	217.8	14'
C202	178	135	81	80	1,610	149.7	14'
C203	210	154	126	120	2,105	195.8	14'
C204	176	135	81	80	1,610	149.7	14'
C202 – C203	472	360	220	250	3,716	345.5	14'
C203 – C204	472	360	218	250	3,715	345.5	14'
C202 – C204	694		330	350	5,326	495.3	14'
C205	251	185	143	120	2,344	218	14'
C206	294	216	144	120	2,614	243.1	14'
C207	173	130	76	70	1,592	148.1	12'
C208	144	113	70	70	1,430	133.0	12'
C209	140	112	78	90	1,488	138.3	12'
C210	144	113	70	70	1,430	133.0	12'
C208 – C209	321	235	159	170	2,918	271.4	12'
C209 – C210	321	235	159	170	2,918	271.4	12'
C208 – C210	483	382	242	240	4,348	404.4	12'
C211	144	113	70	70	1,430	133	12'
C212	140	112	78	90	1,488	138.3	12'
C213	144	113	70	70	1,430	133.0	12'
C211 – C212	321	235	159	170	2,918	271.4	12'
C212 – C213	321	235	159	170	2,918	271.4	12'
C211 – C213	483	382	238	240	4,348	404.4	12'
West Plaza					48,000		

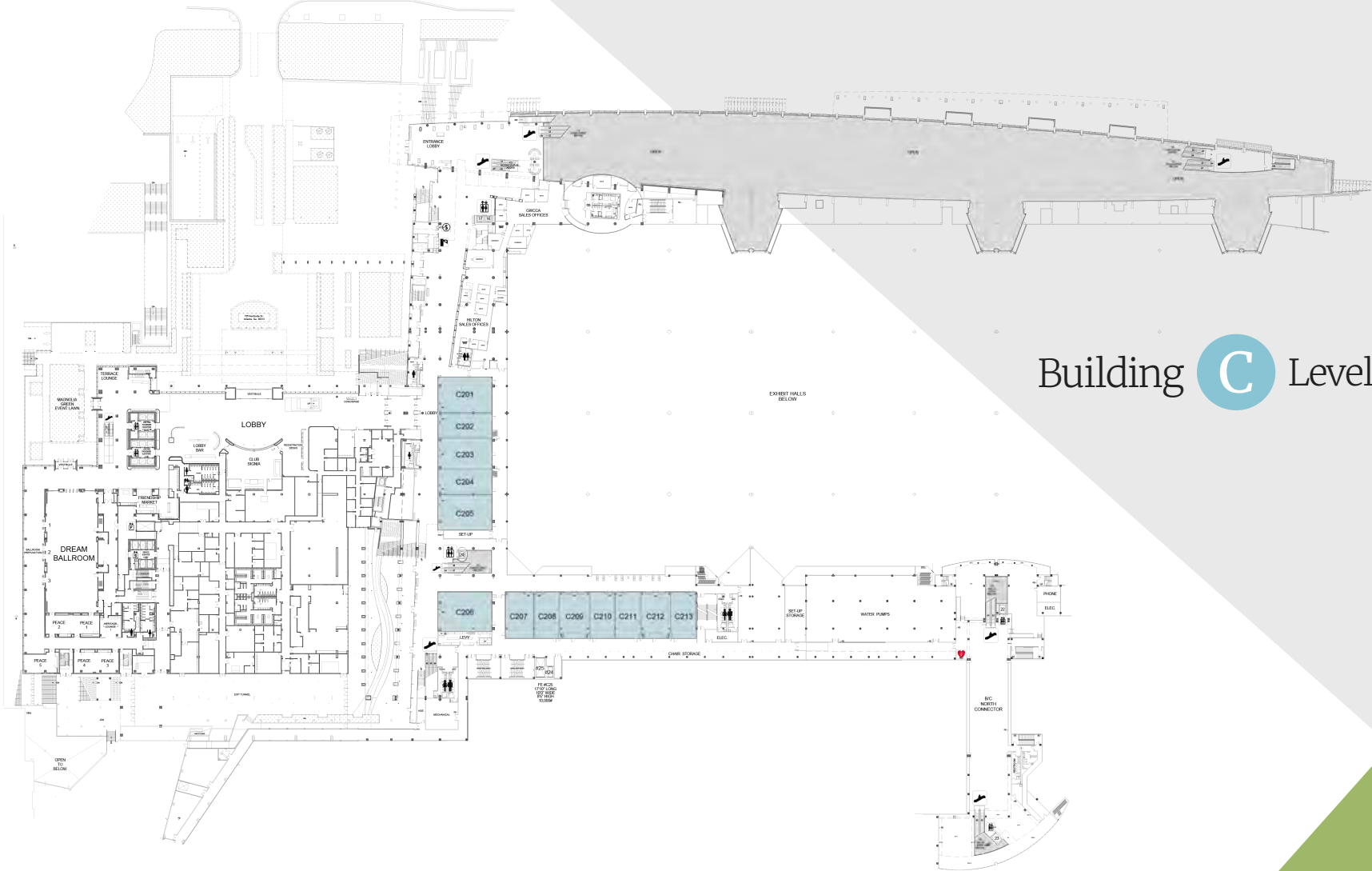

Building **C** Level Two

Building C Level Three Concourse (Ballroom)

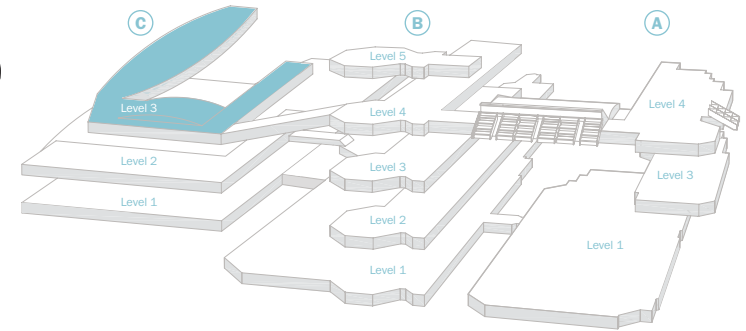

2 Meeting Rooms C301 – C302
Georgia Ballroom Sections 1 – 3

Meeting Rooms							
Room or Area	Theater Capacity	Theater Comfort Set	Classroom Capacity	Banquet Capacity	Usable Area		Ceiling Height
					Sq. Ft.	Sq. Meters	
C301	232	190	124	110	2,288	212.7	16'
C302	385	190	172	190	3,275	304.6	16'

Ballrooms						
Room or Area	Theater Capacity	Classroom Capacity	Banquet Capacity	Usable Area		Ceiling Height
				Sq. Ft.	Sq. Meters	
Georgia Ballroom Building C – Sections 1-3	3,600	1,544	2,010	25,722	2,392.1	35' – 40'
Georgia Ballroom Building C – Sections 1-2 or 2-3	2,340	1,089	1,240	18,047	1,678.4	35' – 40'
Georgia Ballroom Building C – Section 1	940	426	430	7,685	714.7	35' – 40'
Georgia Ballroom Building C – Section 2	1,472	714	720	10,378	965.1	35' – 40'
Georgia Ballroom Building C – Section 3	940	426	430	7,685	714.7	35' – 40'
Georgia Ballroom Galleria				2,100		
Georgia Ballroom Outdoors Patio				8,540		



Georgia Ballroom

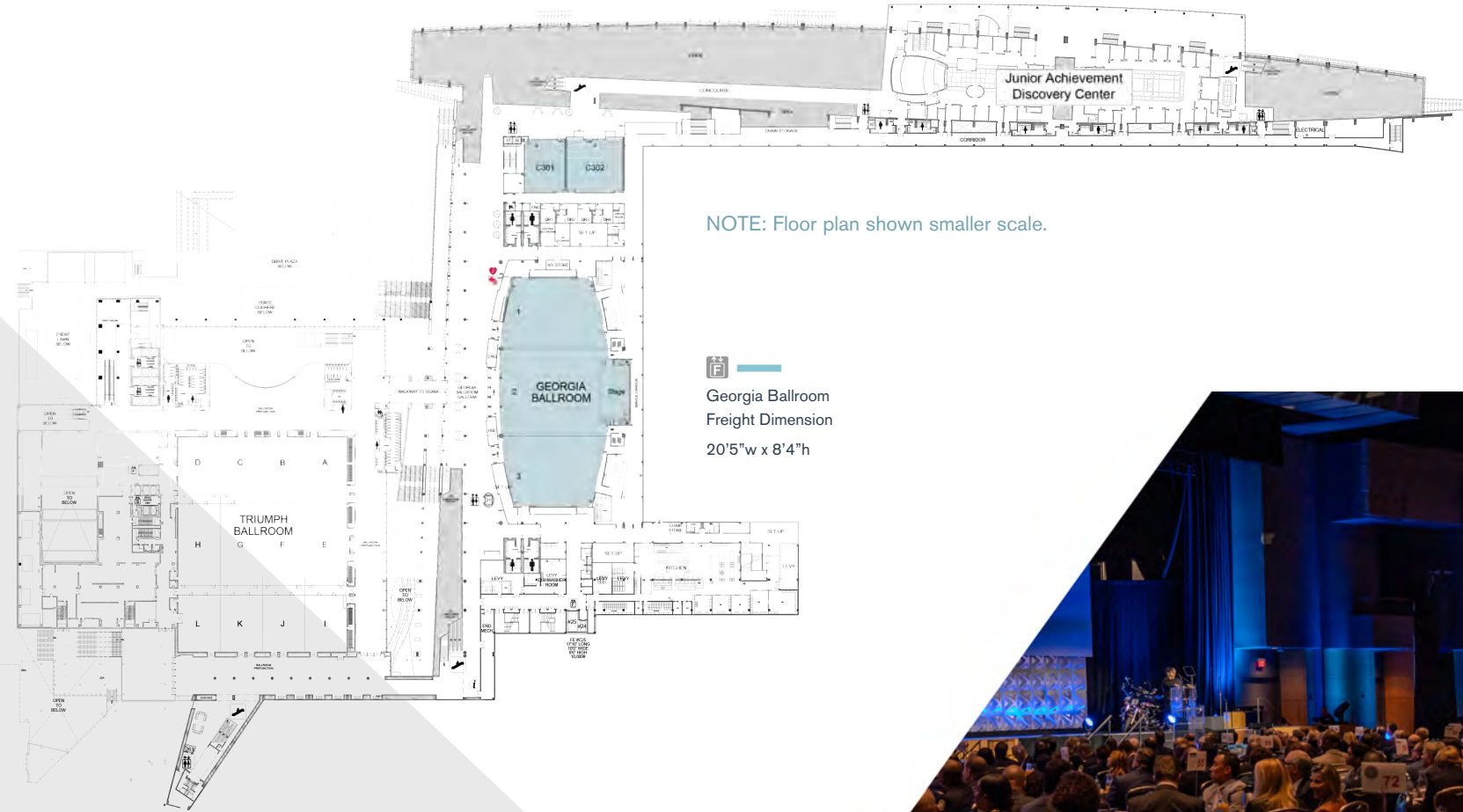

Building **C** Level Three

Georgia Ballroom



Centennial Olympic Park

- 23-acre park commemorating the 1996 Centennial Olympic Games
- Featuring life-size Olympic Rings signaling one of many new entrances into the park
- Located in the heart of downtown, connecting Atlanta's hotel district to the Georgia World Congress Center & Mercedes Benz Stadium
- Six-acre Great Lawn provides natural seating for 20,000
- Newly upgraded Southern Co. Amphitheatre with tiered seating for 1,200
- Engaging water features that add a unique backdrop to your event
- Fountain of Rings features daily fountain shows with synchronized music and light displays
- Ideal for corporate receptions, music concerts, promotional campaigns, film shoots, and other special events

Great Lawn
 Fountain of Rings
 Garden Pavilion East
 Garden Pavilion North
 Southern Company Amphitheater



West Lawn of Centennial Olympic Park

GEORGIA WORLD CONGRESS CENTER

ENTIRE PARK

22,000 capacity
21 total acres

NORTH PARK

18,000 capacity

SOUTH PARK

6,000 capacity





Georgia World Congress Center Authority

Sales@gwcc.com

gwcca.org

Virtual Tour:
gwcca.org/event-planning-guide/events-spaces



gwcca.org/gwcc



gwcca.org/park

Our Neighbor:



mercedesbenzstadium.com